

# T96G



## Product Features

- Adjustable power size EN 2~4
- Adjustable closing & latching speed
- Thermo-constant valve
- Concealed mount
- Cam action
- Track arm (Large as standard & Small as option)
- Single-action door
- Non-handed installation
- Compatible with Fortress electromagnetic hold-open application (EHO)
- T96G can be installed in virtually all doors with minimum thickness of 40mm or more

Power size	2~4
Max. Door width (mm)	1100
Max. Opening Angle	120

## Application Ranges

- Concealed in door
- Concealed in transom

## Installation

- Concealed in door

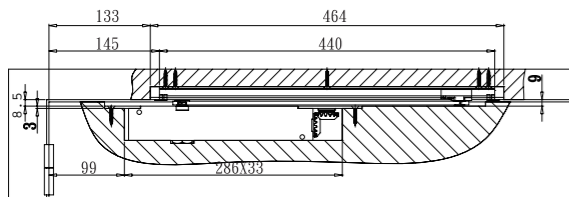

- Concealed in transom

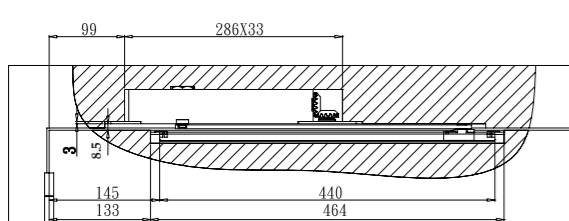

## Finishes

- Anodized aluminum for door closer body and track rail as standard
- Painted – silver, brown, gold, black, white & other RAL colors upon request & discussion

## Dimensions

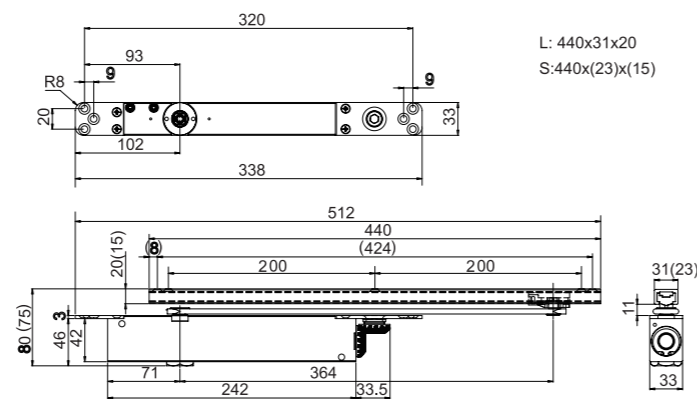

## Accessories

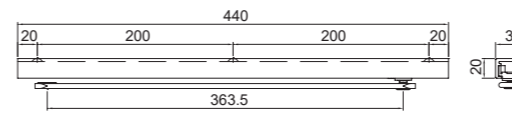

### ZAR-I150 (large)

- Track arm & rail- punched arm
- EN Certified

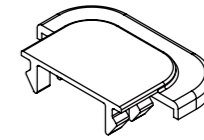

### ZSCR-T136

- End cap
- For track arm & rail: ZAR-I150 (large)

## Options

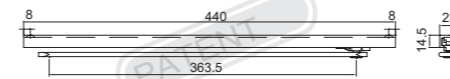

### ZAR-I145 (small)

- Track arm & rail- punched arm
- Zinc alloy block (Patent #: M566248)
- EN certified

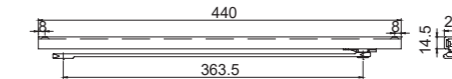

### ZAR-I163 (small)

- Track arm & rail- forged arm
- Zinc alloy block (Patent #: M566248)
- EN certified

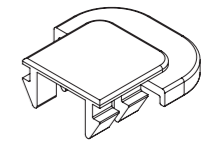

### ZSCR-T012

- End cap
- For track arm & rail: ZAR-I145 (small)

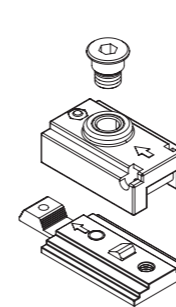

### ZSCR-T126

- Hold-open device
- For track arm & rail: ZAR-I150 (large)

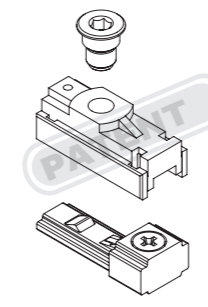

### ZSCR-T116

- Hold-open device
- Zinc alloy block (Patent #: M566248)
- For track arm & rail: ZAR-I145 (small)

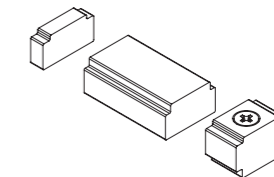

### ZSCR-T111

- Cushion
- For track arm & rail: ZAR-I150 (large)

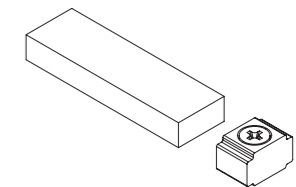

### ZSCR-T109

- Cushion
- For track arm & rail: ZAR-I145 (small)