

C800 series

Rack & Pinion Door Closer with Standard Arm



Product Features:

- Fixed power size 2/3/4/5
- Size 5 UL compliance
- Adjustable closing & latching speed
- Thermo-constant valve
- Surface mount
- Rack & Pinion
- Standard arm

| Power size | 2 | 3 | 4 | 5 |
|------------------------------|--------------|----------------|----------------|---------------|
| Max Door width [Inches (mm)] | 34-1/4 (870) | 37-12/32 (950) | 43-5/16 (1100) | 47-1/4 (1200) |
| Max. Opening Angle | 180 | | | |

Only Size 5 Non UL

Application Ranges:

- Standard door mount on pull side
- Transom mount on push side
- Parallel bracket mount

Finishes:

- Painted – silver, brown, gold, black, white & other RAL colors upon request & discussion

| | A | B | C | D | E | F |
|-----------------------------|---------------|--------------|---------------|---------------|----------|--------------|
| C802 [Inches (mm)] | 8-1/32 (204) | 1-49/64 (45) | 2-7/8 (73) | 7-31/64 (190) | 3/4 (19) | 1-49/64 (45) |
| C803 [Inches (mm)] | 8-47/64 (222) | 1-49/64 (45) | 2-7/8 (73) | 8-3/16 (208) | 3/4 (19) | 1-49/64 (45) |
| C804/5 [Inches (mm)] | 9-27/32 (250) | 1-49/64 (45) | 3-1/64 (76.5) | 9-1/16 (230) | 3/4 (19) | 1-57/64 (48) |

Dimensions:

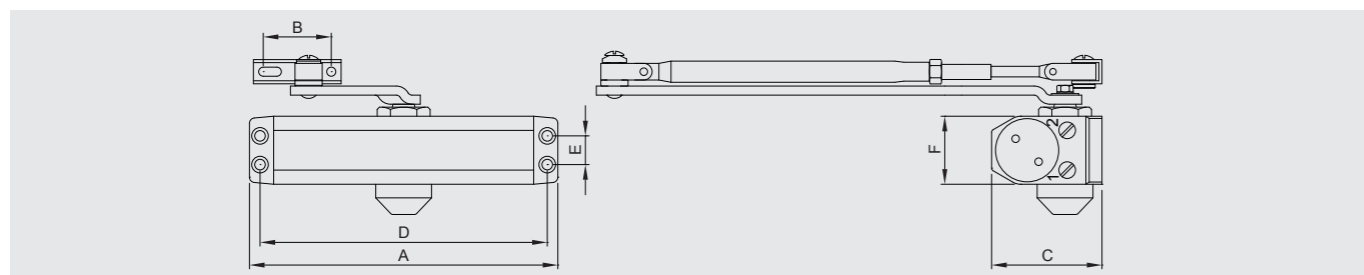

★ This option is not covered by the Certificate

Accessories

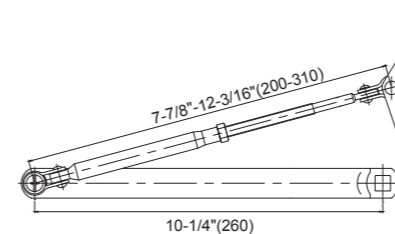

ZAR-A007

- Standard arm
- Non-handed
- UL Certified

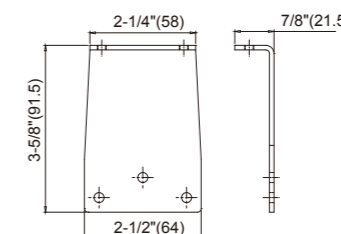

ZPA-H01

- Parallel bracket
- UL Certified

Options

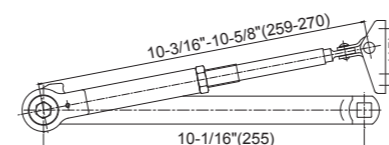

ZAR-B065

- Hold-open arm
- Non-handed

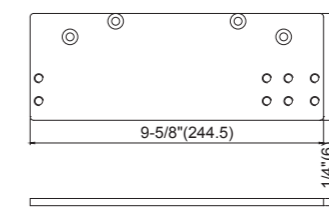

ZMO-J05000

- Drop Plate-Top jamb